



PIPELINE SAFETY TULARE - I STREET PIPELINE REPLACEMENT

Southern California Gas Company (SoCalGas®) will be replacing a section of one of our natural gas transmission pipelines in the Tulare area with new pipe as part of our Pipeline Safety Enhancement Plan. Pipeline replacement activity involves installing new pipeline parallel to the path of the existing pipeline. Next, the existing pipeline is taken out of service and the natural gas is safely removed from it. Then, the new pipeline section is connected to the distribution system and brought into service. Pipeline replacement is one of the many ways SoCalGas maintains the safety and integrity of our natural gas pipeline system.

Replacement Details

End-point Location: **I Street & Paige Avenue**

End-point Location: **I Street & Avenue 196**

Projected Start Date: **Mid-October, 2014**

Projected End Date: **Early February, 2015**

Work Hours: **Monday - Saturday, 7 a.m. - 5 p.m.**

What to Expect

The excavation and pipeline installation work will be conducted in a series of sections along I Street, one-at-a-time. While each active section of I Street is being worked on, the southbound lane will be closed for the length of the section plus a safe distance before and beyond the section. Traffic will alternate between directions on the northbound lane as controlled by flaggers.

When the work on I Street intersects with a cross street, eastbound and westbound traffic will be reduced to one lane, and traffic will alternate between directions as controlled by flaggers. Lane closures will be in effect Monday through Saturday during work hours and marked with traffic cones and signs.

People passing by the work site may see an excavation, equipment, and traffic control signage as well as trucks and other vehicles. The nearby community may also hear some work-related noise and notice an occasional natural gas odor.

We strive to provide continuous natural gas service for our customers while the replacement activities are taking place. Your gas service should continue without interruption. If that changes, a SoCalGas representative will contact you. If you have any questions or concerns about the replacement, please call our Customer Contact Center at **1-800-427-2200**.

For more information on pipeline replacement, visit socialgas.com (search "SAFETY").

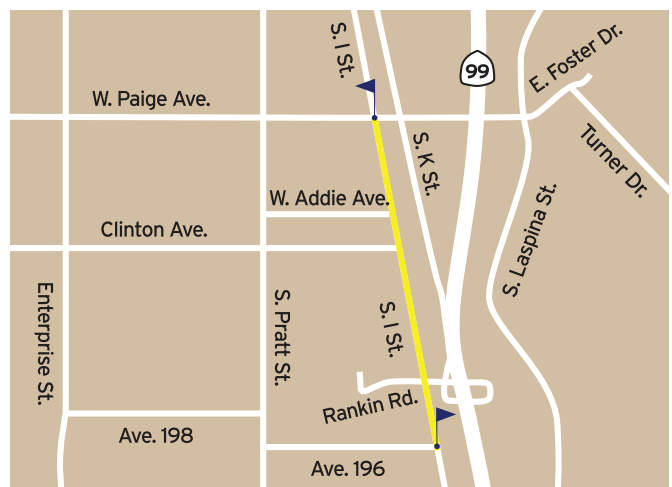

End-points for the Tulare - I Street Pipeline Replacement

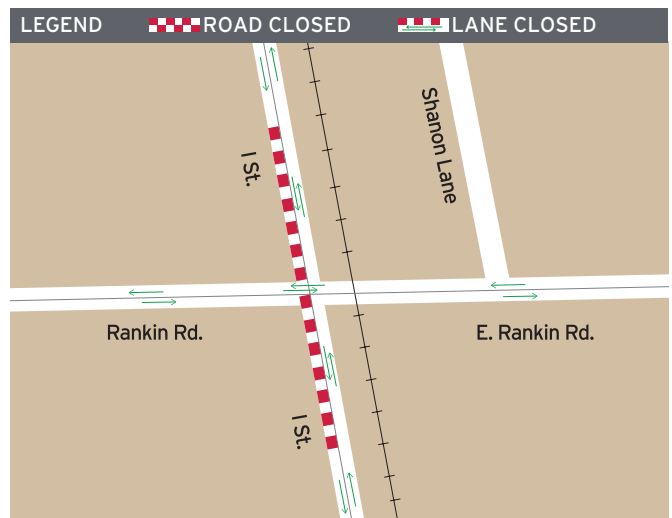

A sample active section of I Street, in which the southbound lane will be closed and traffic will alternate between directions as controlled by flaggers.

On-site signage will provide additional traffic details.

socialgas.com

Residential: 1-800-427-2200

Commercial: 1-800-427-2000

Visit us on: